

glass stopper

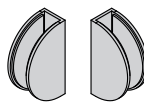

This technical drawing illustrates a mechanical assembly in a semi-transparent exploded view. A central vertical shaft is shown with a break in the middle, indicated by two parallel lines. At the top of the shaft, there is a large, curved, bowl-like component. Below this, a cylindrical component is shown in an exploded position, aligned with the shaft. At the bottom of the shaft, there are two identical sets of components, each consisting of a small cylindrical part and a larger, flanged cylindrical part, also shown in exploded positions. The drawing uses clean, black lines on a white background to represent the geometry of the parts.



Secure

**Never use scouring agents to clean the sliding door fittings; rather use commercially available stainless-steel cleaners!**

Beyerle US L.L.C., ABP-Beyerle, it's subsidiaries and agents are not responsible or liable for damage or injury to any persons or property due to improper installation of it's products.  
All liabilities reside solely with the installer.

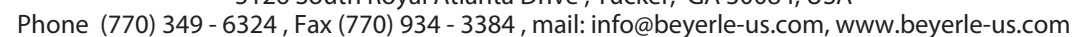

**ABP**  **beyerle**



Fig. 1

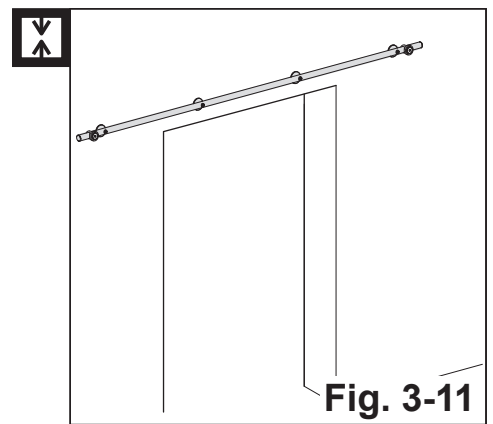

Fig. 2

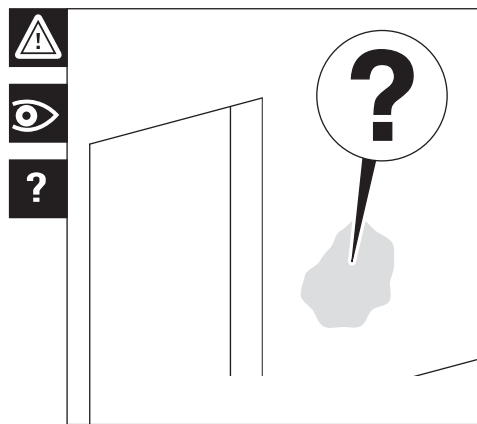

Fig. 3

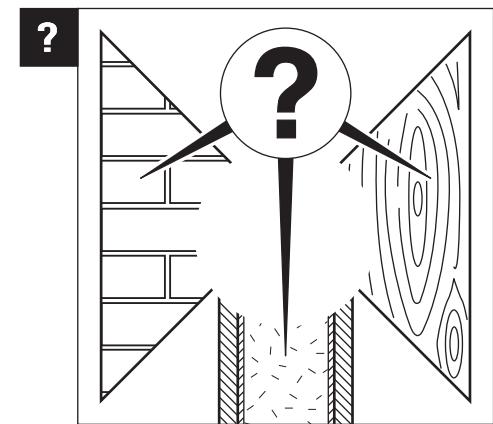

Fig. 4

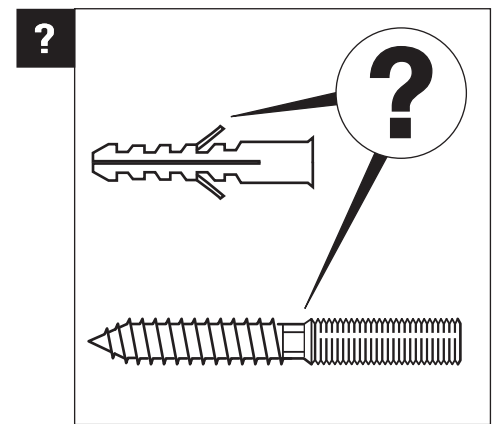

Fig. 5

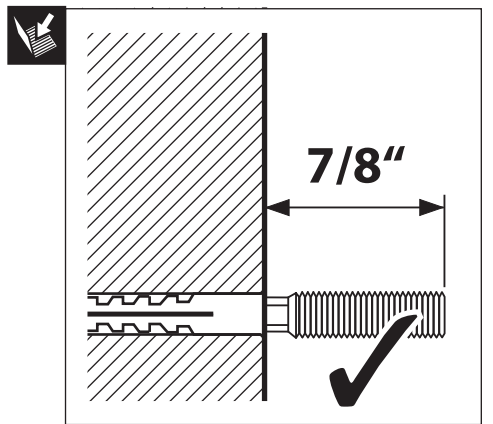

Fig. 6

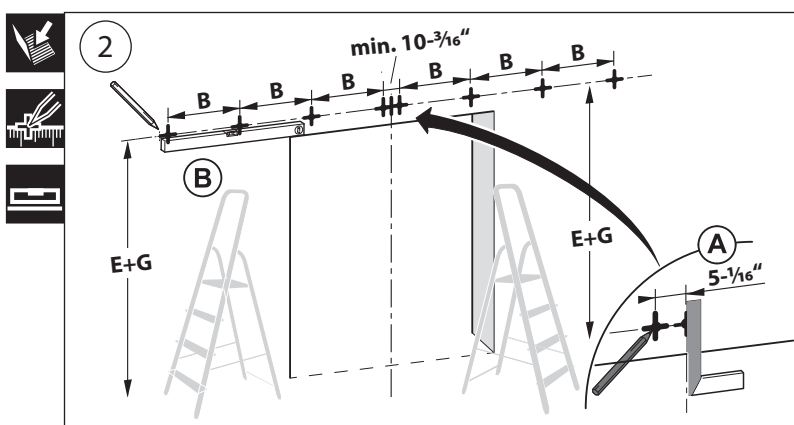

Fig. 7

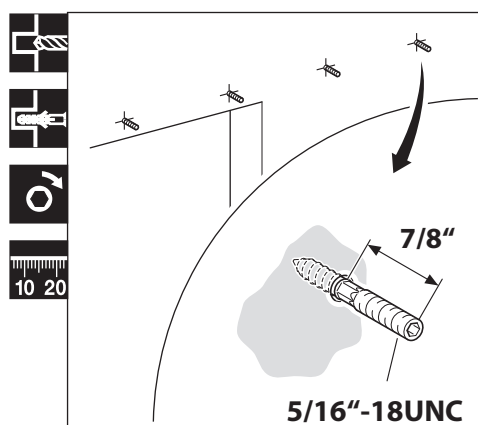

Fig. 8

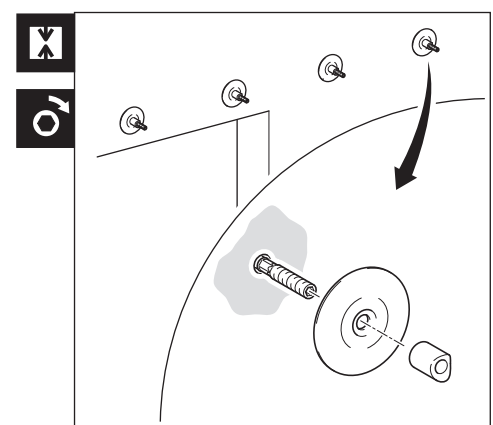

Fig. 9

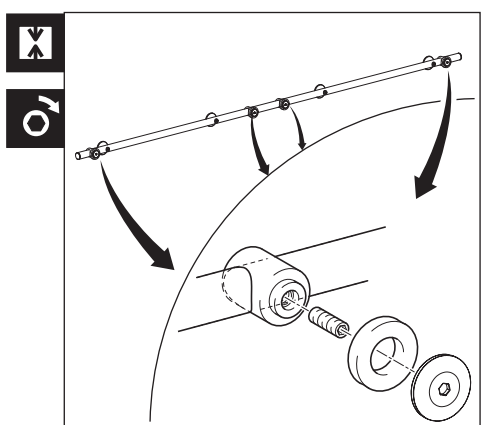

Fig. 10

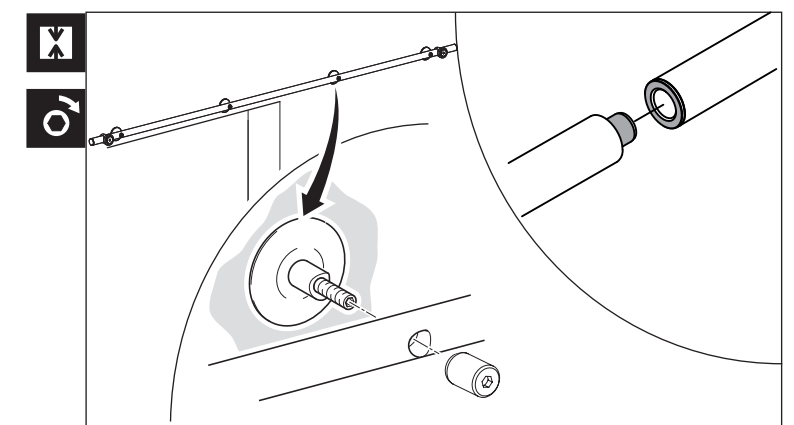

Fig. 11

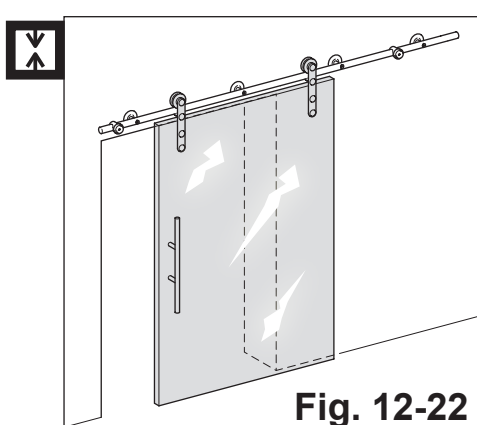

Fig. 12-22

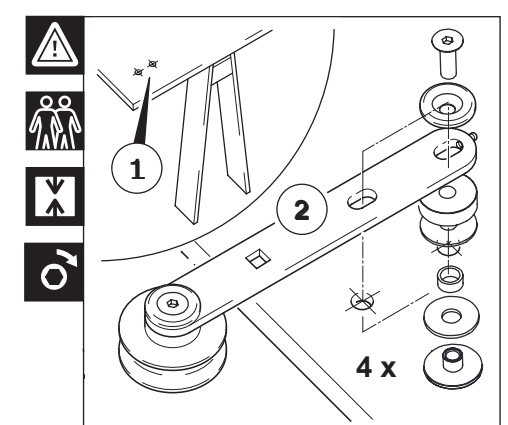

Fig. 13

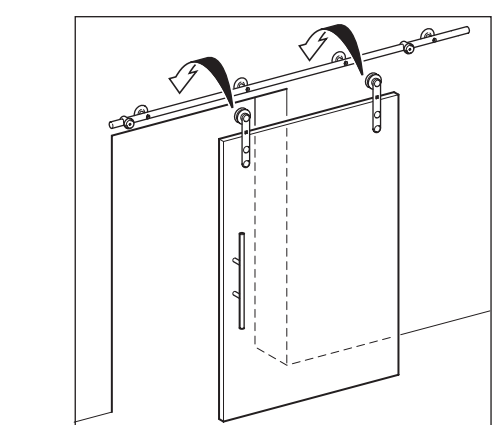

Fig. 14

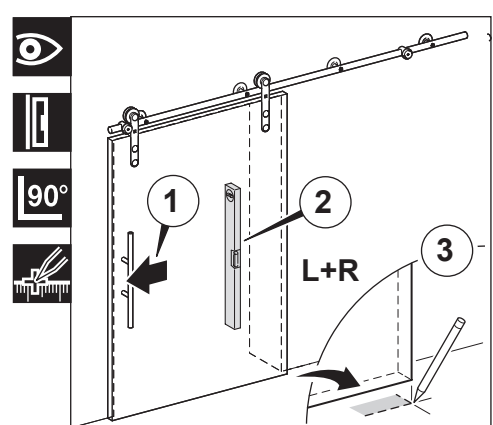

Fig. 15

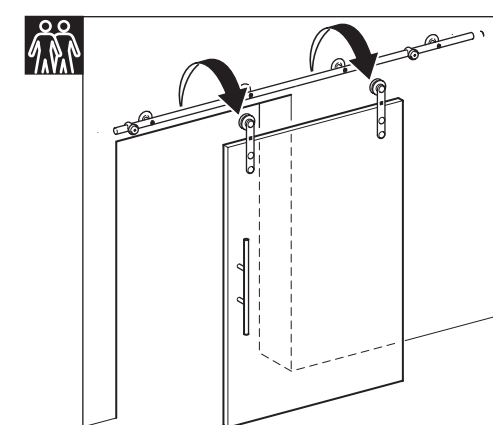

Fig. 16

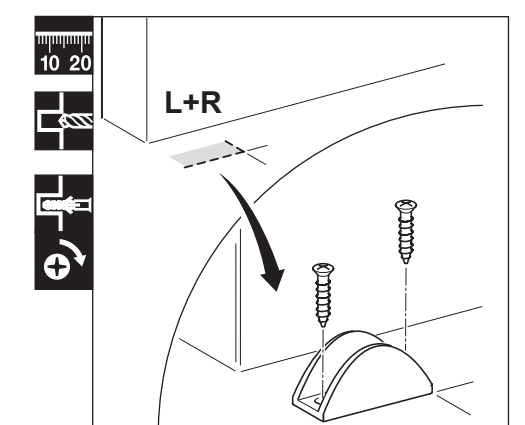

Fig. 17

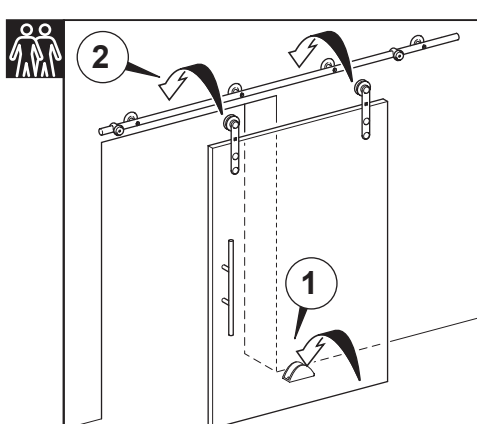

Fig. 18

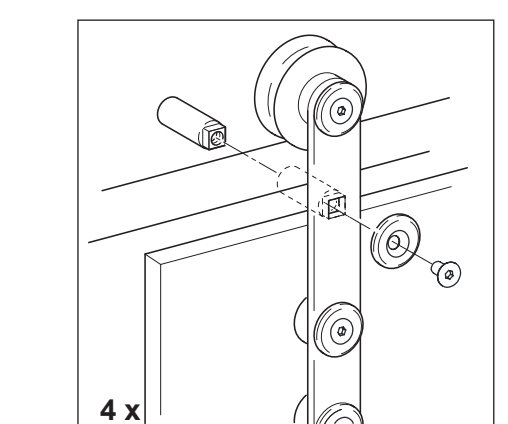

Fig. 19

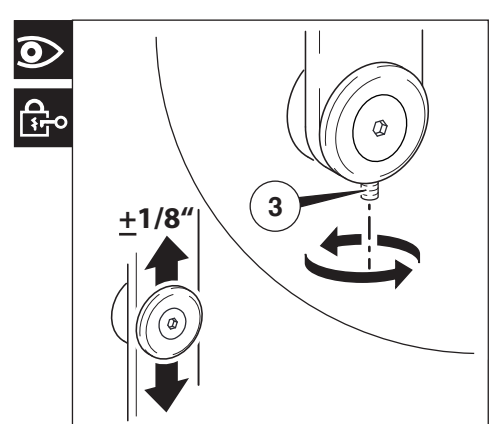

Fig. 20

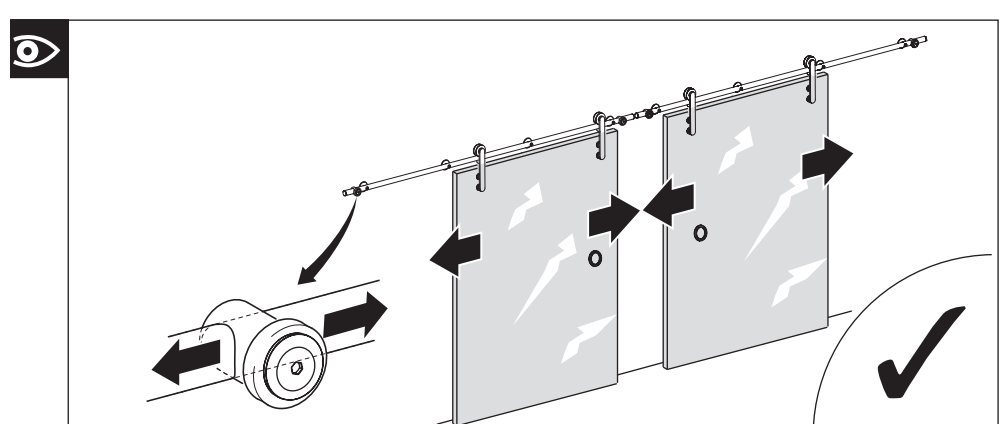

Fig. 21

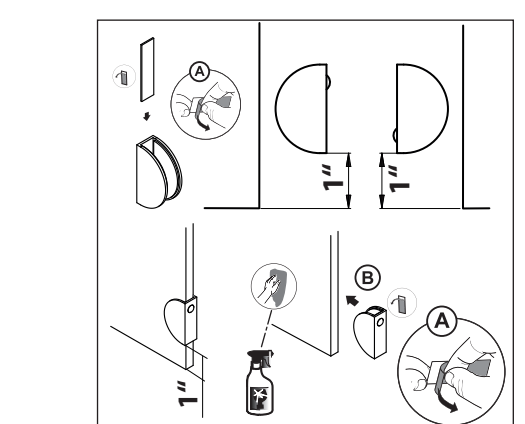

Fig. 22